

EMSVG 20

Pressure compensation cable gland, brass

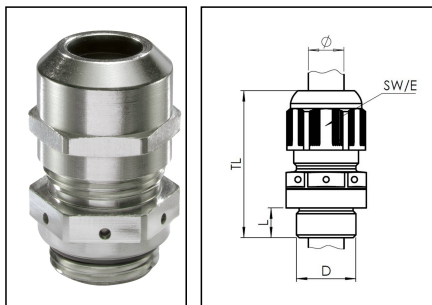

Products may differ in size, colour and appearance to those shown. If you require further information or customisation, please contact us directly.



| | |
|--------------------------|---------------------|
| Material cable gland | Brass nickel-plated |
| Material membrane | ePTFE |
| Material sealing gasket | EPDM |
| Airflow at 70mbar | 55 LH |
| Temp. range min | -40 °C |
| Temp. range max | 100 °C |
| Protection class | IP68 / IP69 |
| Thread type | M |
| Ø Connection thread D | 20 |
| Lead | 1,5 |
| Length screw-in thread L | 6 mm |
| Ø cable diameter min | 6 mm |
| Ø cable diameter max | 13 mm |
| Ø cable diameter UL | 7,5 mm - 11,3 mm |
| Key width SW | 24 mm |
| Collar diameter (E) | 27 mm |
| Install. torques fitting | 8 N/m |
| Install. torques cap nut | 8 N/m |
| Total length TL | 41 mm - 50 mm |
| Order no. nickel-plated | 10065900 |
| Type | EMSVG 20 |
| Packing unit | 1 |
| ETIM-Classification | EC000441 |

Your Contact:

WISKA UK Ltd.

Unit 7, Hurling Way · St. Columb Major Business Park · TR9 6SX, St. Columb Major, Cornwall · Great Britain

☎ +44-12-08816062 · 📠 +44-12-08816708

info@wiska.co.uk · www.wiska.co.uk

Recommended accessories



| | |
|----------------------|----------|
| RDE 20 | 10062185 |
| EMMU 20 | 10063143 |
| BS 13 | 10064010 |
| MFD 20/03/040 | 10064341 |
| MFD 20/03/045 | 10102306 |

29.04.2021

Your Contact:

WISKA UK Ltd.

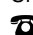
Unit 7, Hurling Way · St. Columb Major Business Park · TR9 6SX, St. Columb Major, Cornwall · Great Britain

 +44-12-08816062 ·  +44-12-08816708

info@wiska.co.uk · www.wiska.co.uk

Other technical data on request / subject to change without notice

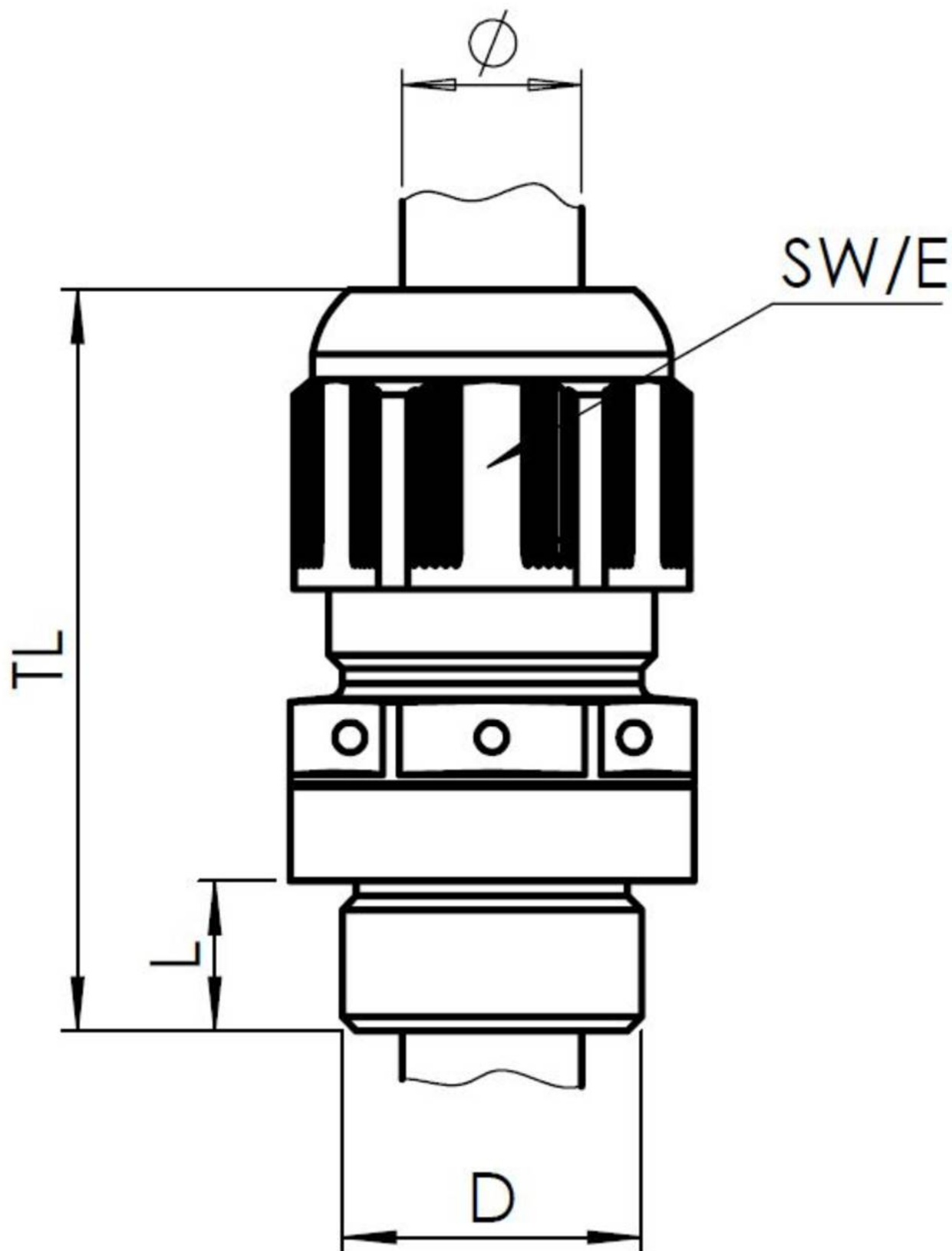

Your Contact:

WISKA UK Ltd.

Unit 7, Hurling Way · St. Columb Major Business Park · TR9 6SX, St. Columb Major, Cornwall · Great Britain

☎ +44-12-08816062 · 📠 +44-12-08816708

info@wiska.co.uk · www.wiska.co.uk

Other technical data on request / subject to change without notice