

Building Light Control

Luminaire mountable mini PIR

Product Sheet



Wirelessly control any make or type of luminaire

The Mymesh add-on PIR is designed to be fitted into a luminaire casing providing a highly sensitive presence sensor that connects easily to the Micro BLC. It enables you to control a single or group of nodes (e.g. lighting fixtures or blinds) based on the presence of occupants.

Simply plug it in, commission the micro BLC with the preferred settings and start using the sensor to your liking. A grommet is supplied to push fit into a 11mm cut out hole, which the PIR then is pushed into the rear of the grommet until it is level with the front panel and is locked in place.

Detection

- PIR Slight motion detection type
- Typical installation height 3 m with slow movement speed
- Range: Horizontal 360°, Vertical 104° approx. 5m diameter ground coverage

Installation

Connect to Mymesh micro-BLC via a plug and play 500mm Mymesh approved lead assembly.

- Install in the luminaire /panel.

Technical

Electrical

- powered by micro-BLC

Product codes

Article number: BLC.6401.001PL

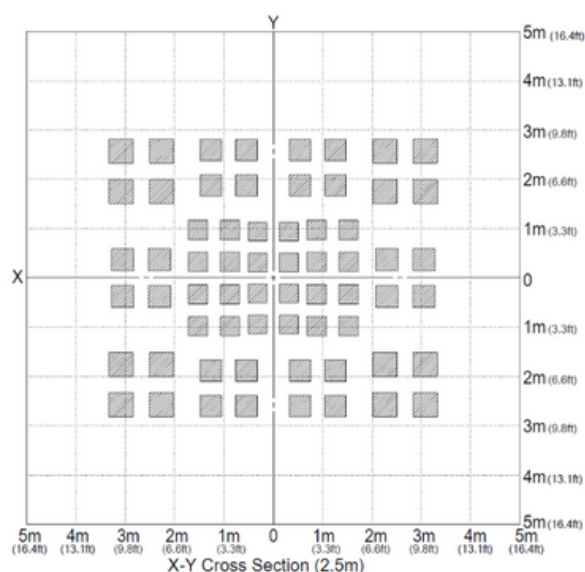

Hole cut-out
11.00mm in panel

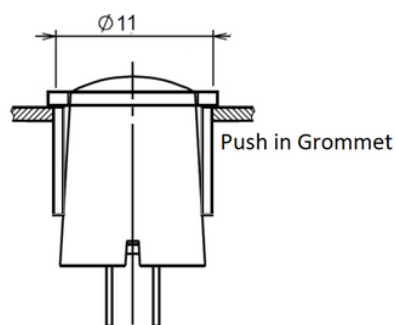

PIR Size

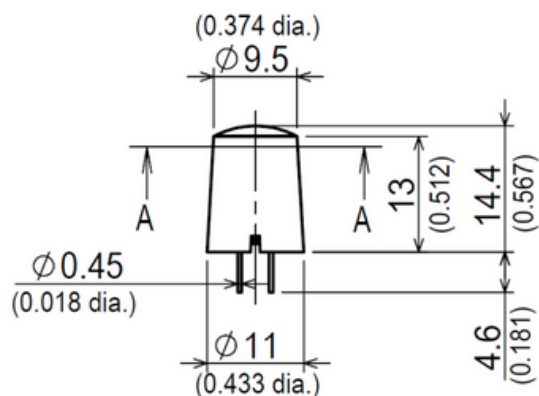

IP rating
IP20

Cable length
500mm plug and play cable harness

Product Code
BLC.6402.001PL - PIR Slight motion detection type

A smarter way to connect your building

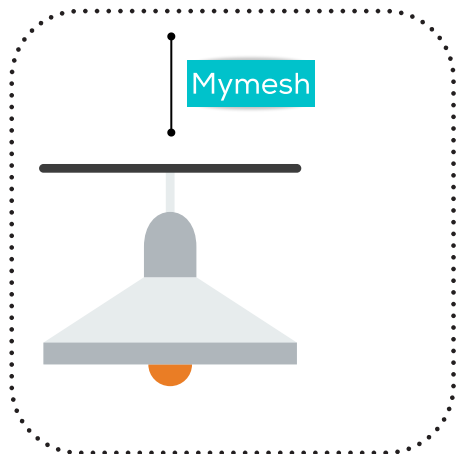

Prime Light Electrical Ltd
e: sales@primelight.co.uk
t: 0208 968 2000
w: www.primelight.co.uk